

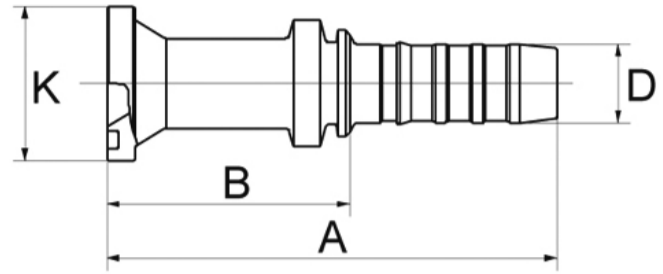

FL

GS Pressarmaturen SAE-Flansch 3000 psi Raccords à sertir, GS à bride SAE 3000 psi



Material: Stahl promatisiert
Medium: Hydrauliköl
Eigenschaften/Vorteile: DN 10-25 bis 350 bar zugelassen
Norm: DIN 20078R
Gewindefamilie: K / SFL-3
Hinweis: GSM = Pressarmatur mit Hülse;
 Code61: 06-08-10.-12-16:
 Druck max. 350 bar, 20-:280 bar,
 24-32: 210 bar

Matériel: acier promatisé
Fonctionne avec: huile hydraulique
Caractéristiques, avantages: autorisé jusqu'à 350 bar temporairement
Norme: DIN 20078R
Famille de filetage: K / SFL-3
Indication: GSM = douille à sertir;
 Code61: 06-08-10.-12-16:
 Pression max. 350 bar,
 20-:280 bar, 24-32: 210 bar

Bestell-Nr.	Code	DN	DN	max. Druck	Flansch	Flansch	A	B	K	p max.
N° de commande	Code	DN	DN	pression max.	Flasque	Flasque	A	B	K	p max.
		mm	Ø	bar	Ø zoll	Ø mm	mm	mm	mm	bar
06GS08FL	06	10	3/8"	350	1/2"	30.2	90.0	54.2	30.2	350
08GS08FL	08	12	1/2"	350	1/2"	30.2	93.0	55.5	30.2	350
08GS12FL	08	12	1/2"	350	3/4"	38.1	98.0	60.5	38.1	350
10GS12FL	10	16	5/8"	350	3/4"	38.1	109.0	58.7	38.1	350
12GS08FL	12	20	3/4"	350	1/2"	30.2	112.0	61.0	30.2	350
12GS12FL	12	20	3/4"	350	3/4"	38.1	111.0	60.0	38.1	350
12GS16FL	12	20	3/4"	350	1"	44.5	111.0	60.0	44.5	350
12GS20FL	12	20	3/4"	350	1-1/4"	50.8	111.0	60.0	50.8	280
16GS16FL	16	25	1"	350	1"	44.5	125.0	68.6	44.5	350
16GS20FL	16	25	1"	350	1-1/4"	50.8	125.0	68.2	50.8	280
16GS24FL	16	25	1"	350	1-1/2"	60.3	125.0	59.9	60.5	210
20GS16FL	20	32	1-1/4"	280	1"	44.5	136.0	64.9	44.5	350
20GS20FL	20	32	1-1/4"	280	1-1/4"	50.8	146.0	74.9	50.8	280
20GS24FL	20	32	1-1/4"	280	1-1/2"	60.3	160.0	88.9	60.3	210
24GS24FL	24	40	1-1/2"	210	1-1/2"	60.3	166.0	91.7	60.3	210
24GS32FL	24	40	1-1/2"	210	2"	71.4	145.0	70.7	71.4	210
24GSP24FL	24	40	1-1/2"	210	1-1/2"	60.3	152.9	79.3	60.3	210
24GSP32FL	24	40	1-1/2"	210	2"	71.4	152.9	79.3	71.4	210
24GSM24FL	24	40	1-1/2"	210	1-1/2"	60.3	180	85	60.3	210
32GSP32FL	32	50	2"	210	2"	71.4	159.3	67.3	71.4	210
32GSM32FL	32	50	2"	210	2"	71.4	251	137	71.4	210

Achtung: Bei SAE 3000 PSI Flanscharmaturen ist der maximale Druck durch den Flansch begrenzt!